

DIMENSION TABLE

POS	DIM.A	DIM.B
2x1		5.4
2x2	4.2	9.6
2x3	8.4	13.8
2x4	12.6	18.0
2x5	16.8	22.2
2x6	21.0	26.4
2x7	25.2	30.6
2x8	29.4	34.8
2x9	33.6	39.0
2x10	37.8	43.2
2x11	42.0	47.4
2x12	46.2	51.6

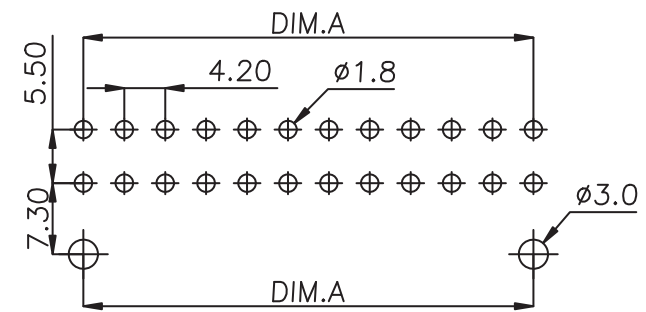
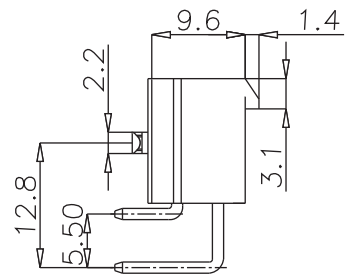
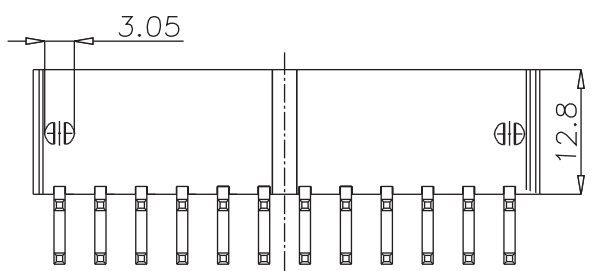

RECOMMENDED PCB LAYOUT

ELECTRICAL:

VOLTAGE RATING: 250VAC RMS
 CURRENT RATING - REFER TO TABLE 1.
 CONTACT RESISTANCE: 20 milliohm Max.
 INSULATOR RESISTANCE: 1000 Megaohm Min.
 DIELECTRIC WITHSTANDING VOLTAGE: 1500VAC FOR 1 MIN.
 OPERATING TEMPERATURE: -40° C TO +85° C

MATERIAL:

INSULATOR: 30 % Glass Re-enforced Thermoplastic; PA66
 CONTACT: Copper Alloy
 PLATING: Tin Plated 120u" Min. Over 30 ~ 50m" Nickel Overall
 SOLDERABILITY: 245 ± 5° C; 95% Coverage
 RESISTANCE TO WAVE SOLDERING HEAT: 260 ± 2° C; 5 Sec.

MECHANICAL:

RETENTION FORCE: 1.5 Kgf Min. Per Contact

HOW TO ORDER:

W 0 5 2 - X X 0 X - 1 1 X - Z

TABLE 1

AWG	POS	2~6	8~12	14~20	22~2
#16	9A	8A	7A	6A	
#18	9A	8A	7A	6A	
#20	7A	6A	5A	5A	
#22	5A	4A	4A	4A	
#24	4A	3A	3A	3A	
#26	3A	2A	2A	2A	
#28	2A	1A	1A	1A	

NUMBER OF CONTACTS:

02 Thru 24

VARIATIONS:

- 1 - UL94 V-2 Natural Color
- 2 - UL94 V-0 Natural Color
- 3- UL94 V-2 Black Color
- 4 - UL94 V-0 Black Color

PLATING OVERALL:

- 1 - FULL TIN OVER NICKEL
- 2 - FULL Au FLASH

SELECTIVE PLATING:

- 0 - Au FLASH CONTACT AREA/TIN TAIL
- 3 - 15u" Au CONTACT AREA/TIN TAIL
- 4 - 30u" Au CONTACT AREA/TIN TAIL

MOUNTING OPTION:

- 1 - W/ PEG

RoHS COMPLIANT

Rev	Drawn	Checked	Apprvd	Date
0	G.T.	G.T.	G.T.	12/06/05
A	B.S.	B.S.	S.M.	07/16/12

SMP TECHNOLOGY, INC.
 Power Connector; 4.2mm Pitch; Right Angle; With Mounting Peg

SCALE

TOL. DEC. .X +/- 0.35 .XX +/- 0.25 .XXX +/- ANGLE +/- UNIT: mm / in

SERIES: W 052-XX0X-11X-Z Pg: 1