

CONNECTOR WITHOUT MOUNTING PIN

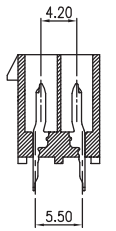

SECTION A-A

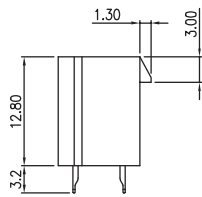
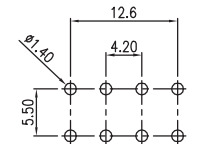
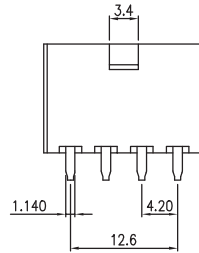
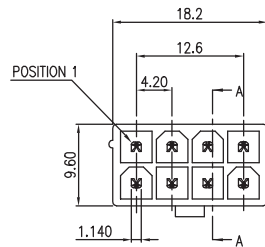

RECOMMENDED PCB LAYOUT

CONNECTOR WITH MOUNTING PIN

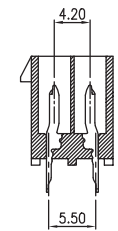
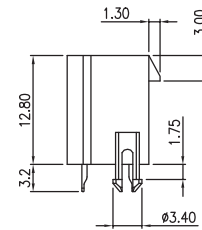

SECTION A-A

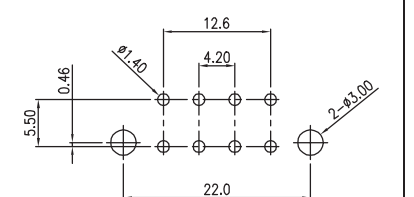
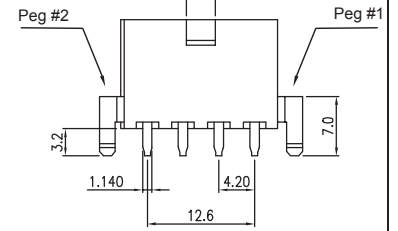
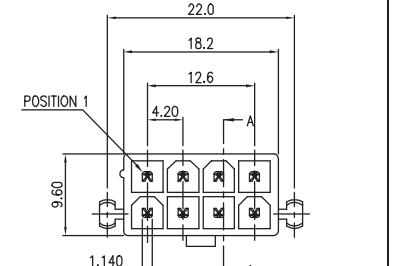

RECOMMENDED PCB LAYOUT

HOW TO ORDER:

W 0 5 2 - 0 8 0 X - X 0 1 - Z

SERIES:

TYPE NUMBER:

NUMBER OF CONTACTS:
02 Thru 24

VARIATIONS:
1 - UL94V-2
2 - UL94V-0

MOUNTING OPTION:

- 1 - W/ PEG
- 2 - W/OUT PEG
- 3 - W/ PEG #1 (right)
- 4 - W/ PEG #2 (left)

PLATING OVERALL:

- 1 - FULL TIN OVER NICKEL
- 2 - FULL Au FLASH

SELECTIVE PLATING:

- 0 - Au FLASH CONTACT AREA/TIN TAIL
- 3 - 15u" Au CONTACT AREA/TIN TAIL
- 4 - 30u" Au CONTACT AREA/TIN TAIL

RoHS COMPLIANT

ELECTRICAL:

VOLTAGE RATING: 250VAC RMS
CURRENT: 8A
CONTACT RESISTANCE: 20m ΩMax.
INSULATOR RESISTANCE: 1000M ΩMin.
DIELECTRIC WITHSTANDING VOLTAGE: 1500VAC FOR 1 MIN.
OPERATING TEMPERATURE: -25° C TO +85° C

MATERIAL:

INSULATOR: Glass Re-enforced Thermoplastic
CONTACT: Copper Alloy
PLATING: Tin Plated 120u" Min. Over 30 ~ 50u" Nickel Overall

MECHANICAL:

RETENTION FORCE: 1.5 Kgf Min. Per Contact

| | | | | | |
|-----------|-----------------------------|--------------|----------|---|---------------|
| Rev | | Apv. | Date | SMP TECHNOLOGY, INC. | |
| 0 | Issued | S.E. | 9/15/99 | | |
| A | Revised for RoHS Compliance | G.T. | 11/03/05 | | |
| | | | | Power Connector; 4.2mm Pitch; With and Without Mounting Peg | |
| SCALE | MAT'L | FINISH | | 8 Position | |
| TOL. DEC. | .X +/- 0.35 | .XX +/- 0.25 | .XXX +/- | ANGLE +/- | UNIT: mm / in |
| | | | | SERIES: W 052-080X-X01-Z | Pg: 1 |