

ISOMETRIC VIEW

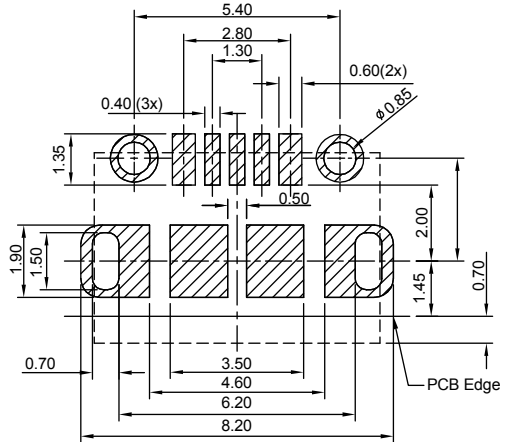

RECOMMENDED PCB LAYOUT

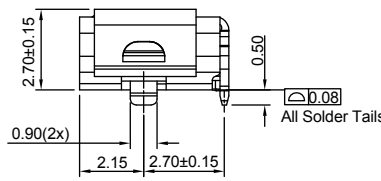
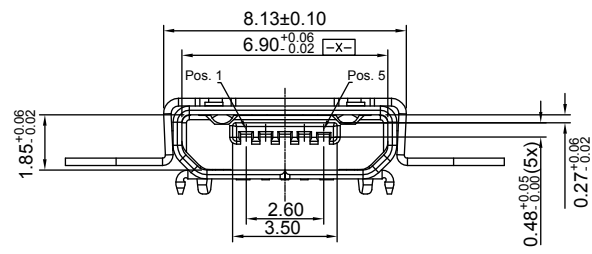
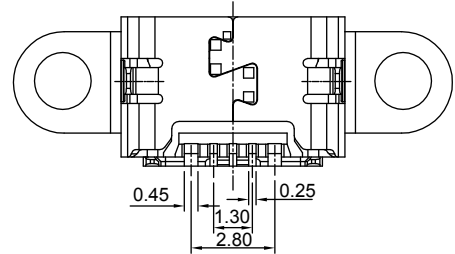

HOW TO ORDER:

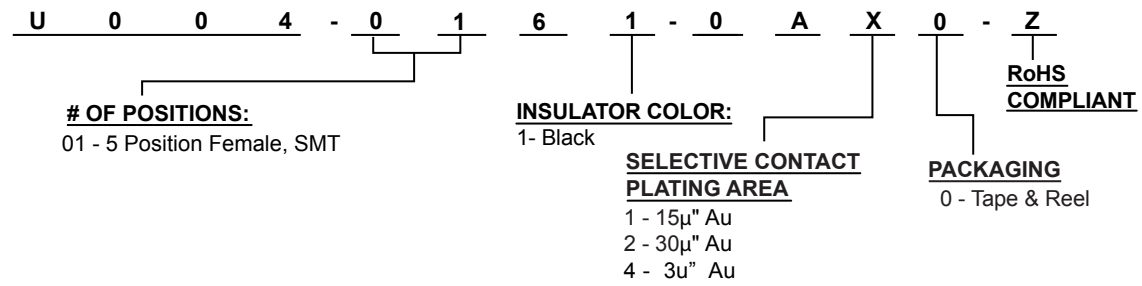

ELECTRICAL:
 VOLTAGE RATING: 5V AC
 CURRENT RATING: 1.0 AMP (Signal Pin ,2,3,4) 2.0 AMP (Power Pin 1,5)
 DIELECTRIC STRENGTH: 500V AC Min.
 INSULATION RESISTANCE: 1000 MΩ Min.
 CONTACT RESISTANCE: 30 mΩ Max.

MATERIALS:
 HOUSING: High Temperature Thermoplastic, UL94-VO;LCP
 COLOR: Black
 CONTACT PLATING: Selective Gold Plating in Contact Area Over 50~120u" Nickel
 SHELL: Stainless Steel over 30-120u" Nickel
 TEMPERATURE RANGE: -30°C to +80°C
 CONTACT: Copper Alloy C7025

Rev	Drawn	Checked	Approved	Date
0	B.S.	S.M.	S.M.	11/21/19

SMP TECHNOLOGY, INC.

Micro USB Type B Receptacle, 5 Position, Surface Mount,
 With Hold Down Bracket

Scale: N/A
 Tolerance : Dimension .X +/- 0.20 .XX +/- 0.15 .XXX +/- 0.10

SERIES: U004-0161-0AX0-Z Pg: 1