

RECOMMENDED PCB LAYOUT (PCB T=1.4~1.6mm)
COMPONENT SIDE

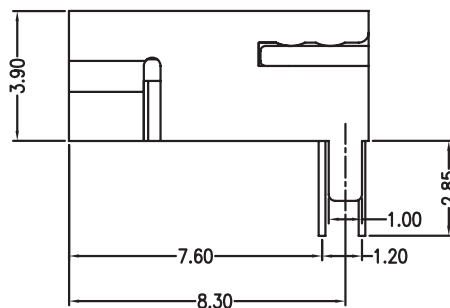
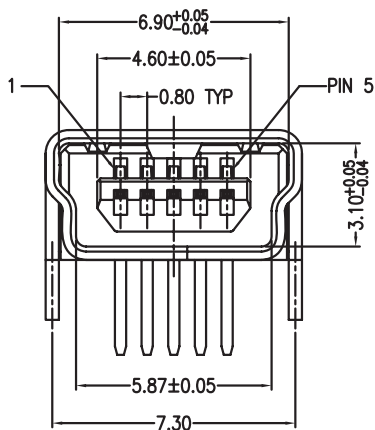

ELECTRICAL:

CURRENT RATING: 0.5A
 CONTACT RESISTANCE:
 < 30 Milliohm Max.
 INSULATION RESISTANCE:
 > 1000 Mgeaohm Min.
 DIELECTRIC WITHSTANDING VOLTAGE:
 750V (rms) AC for 1 Minute
 OPERATING TEMPERATURE: -55° C to +125° C

MATERIAL:

INSULATOR: Thermoplastic UL94V-0
 CONTACTS: Phosphor Bronze
 CONTACT PLATING:
 Gold Plating over Nickel on Contact Area,
 Tin Plating on Terminal
 SHELL: Copper Alloy
 SHELL PLATING: Nickel

HOW TO ORDER:

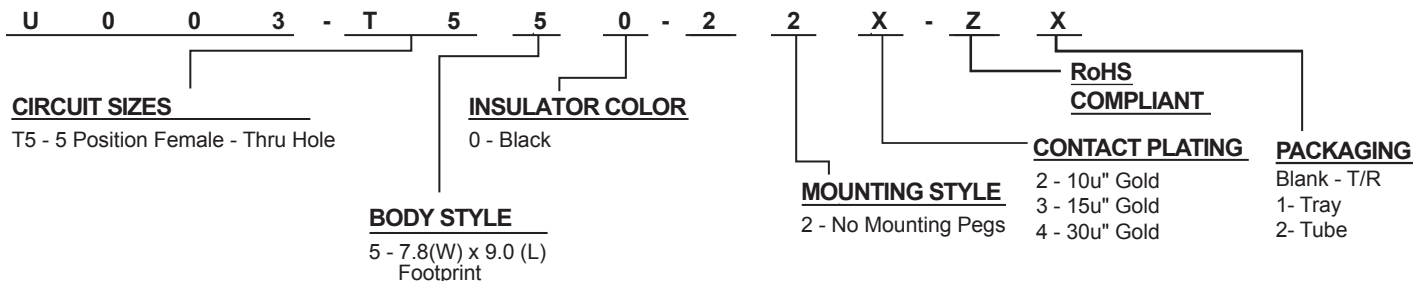

| Rev | Drawn | Checked | Approved | Date |
|-----|-------|---------|----------|---------|
| 0 | B.S. | S.M. | S.M. | 1/30/07 |
| | | | | |
| | | | | |

SMP TECHNOLOGY, INC.
 Mini USB, 5 Position, Right Angle Female, Thru Hole
 PC Tail for 1.4~1.6mm PCB , 7.8 x 9.0 Profile, Rear PCB
 Tab

SCALE:n/a
 TOL. DEC. .X +/- 0.30 .XX +/- 0.30 .XXX +/- 0.30 ANGLE +/- 3° UNIT: mm