

**MATERIAL:**

INSULATOR: Thermoplastic 30% Glass Filled, UL94V0  
 Blue (Pantone 300C)  
 CONTACTS: Phosphor Bronze  
 CONTACT PLATING:  
 Selective Gold Plating over Nickel on Contact Area,  
 Tin Plating on Terminal  
 SHELL: Copper Alloy  
 SHELL PLATING: Nickel

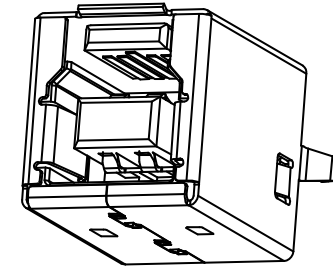

**ISOMETRIC VIEW**

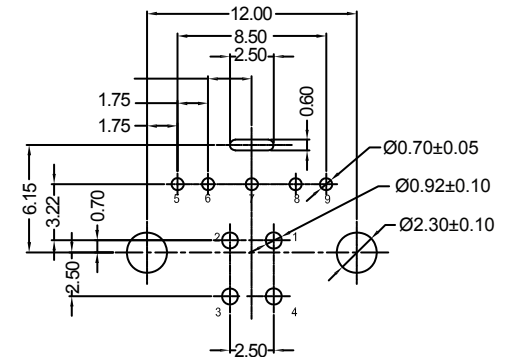
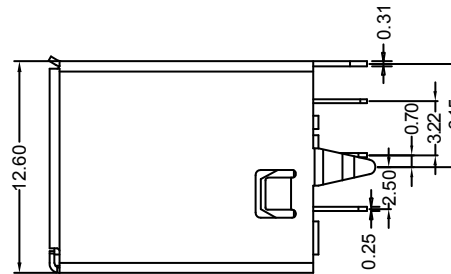
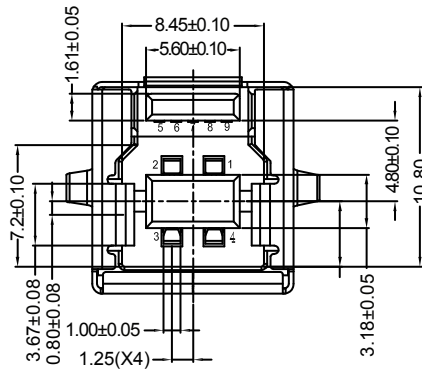

**RECOMMENDED PCB LAYOUT**

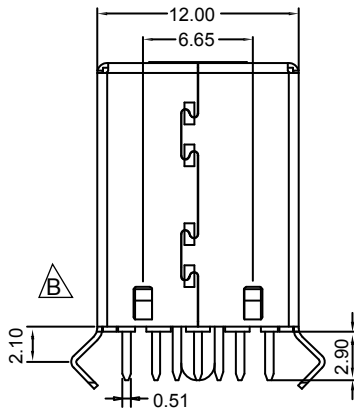

**HOW TO ORDER:**

U 0 0 2 - 0 9 1 2 - 1 4 X - Z X

**NUMBER OF POSITIONS:**  
 09- 09 Positions (USB 3.0)

**INSULATOR COLOR:**  
 2 - Blue (Pantone 300C)

**ORIENTATION:**  
 1 - Vertical Thru Hole

**SHELL STYLE**  
 1 -No Spring Tabs

**SELECTIVE CONTACT PLATING**  
 1 - Gold Flash  
 3 - 15u" Gold  
 4 - 30u" Gold

**RoHS COMPLIANT**

**PACKAGING**  
 Blank - Tray  
 1 - Tape & Reel  
 2 - Tube

Rev	Drawn	Checked	Approved	Date
0	B.S.	S.M.	S.M.	09/23/10
A	B.S.	S.M.	S.M.	01/24/14
B	B.S.	S.M.	S.M.	02/15/18

**SMP TECHNOLOGY, INC.**

USB 3.0 Connector, B Type, Female, 9 Position, Blue Insulator