

Section A-A

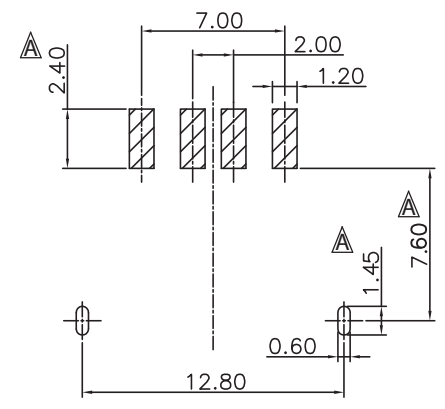

RECOMMENDED PCB LAYOUT

HOW TO ORDER:

U 0 0 1 - 0 4 G X - 0 0 X 0 - Z X

NUMBER OF CONTACTS:
04 - 4 PIN SINGLE PORT

INSULATOR COLOR:
0 - BLACK
1 - WHITE

of LOCKS
0- Standard 2 Locks
(Top, Bottom, Sides)

RoHS COMPLIANT
PACKAGING:
Blank - Tray
1 - Tape & Reel

SELECTIVE CONTACT PLATING:
1 - Gold Flash
2 - 15u" Gold
3 - 30u" Gold
PLATING OVERALL:
0 - FULL Au FLASH
5 - 10u" Au
6 - 15u" Au
7 - 30u" Au

ELECTRICAL:

CURRENT RATING: 1A
CONTACT RESISTANCE:
< 30m milli ohms
INSULATOR RESISTANCE:
> 1000 MOhms Min.
DIELECTRIC WITHSTANDING VOLTAGE:
750VAC for 1 Minute
OPERATING TEMPERATURE: -55° C to +85° C

MATERIAL:

INSULATOR: Thermoplastic UL94V-0
CONTACTS: Copper Alloy
SHELL PLATING: Nickel
CONTACT PLATING: Specified Gold thickness over 50u" Nickel in contact area;
100u" Tin over 50u" Nickel in solder tail area (Selective Plating)
or full Gold thickness overall over 50u" Nickel (Plating Overall)

Rev	Drawn	Checked	Approved	Date
0	B.S.	S.M.	S.M.	12/14/13
A	B.S.	S.M.	S.M.	07/15/15

SMP TECHNOLOGY, INC.
Right Angle, Short Body, Surface Mount, 10.00mm; 2 Boarlocks

TOL. DEC. .X +/- 0.20 .XX +/- 0.10 .XXX +/- 0.05 ANGLE +/- UNIT: mm

P/N: U001-04GX-00X0-ZX Pg: 1