

HOUSING+CONTACT+SHELL A

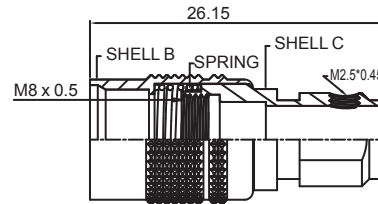

SHELL B + SHELL C + SPRING

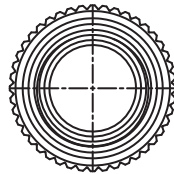
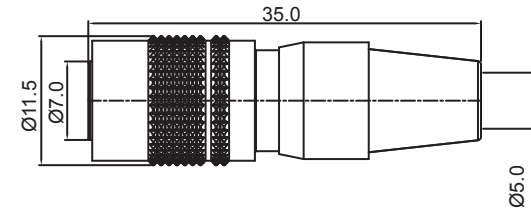

STRAIN RELIEF

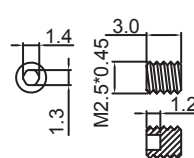

SCREW

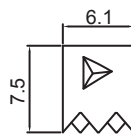

CLAMP

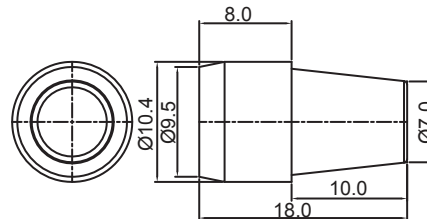

MATERIAL:

HOUSING: Nylon 46 (UL94V-0) Black
 CONTACT: Copper Alloy, Au Flash Plated
 SHELL A: Zinc Alloy
 SHELL B & C: Copper Alloy
 SPRING: Stainless Steel
 SCREW: Steel Alloy, Nickel Plated

HOW TO ORDER:

P R 1 4 - X X 0 1 - 0 0 0 0 - Z

R - Receptacle 4 - Cable Receptacle **# OF POSITIONS:**
 04 - 4 Positions
 05 - 5 Positions
 06 - 6 Positions
 07 - 7 Positions

SERIES:
 1 - Size 7

TERMINATION:
 1 - Solder Cup

RoHS COMPLIANT

| Rev | Drawn | Checked | Approved | Date |
|-----|-------|---------|----------|----------|
| 0 | B.S. | S.M. | S.M. | 08/06/19 |
| | | | | |
| | | | | |

SMP TECHNOLOGY, INC.

Circular Quick Lock Connector (Push Pull Type), Size 7 , Cable Receptacle,

Solder Cup Termination

TOL. DEC. .X +/- 0.20 .XX +/- 0.10 .XXX +/- 0.05 ANGLE +/- 1° UNIT: mm

P/N: PR14-XX01-0000-Z