

CONTACT ARRANGEMENT (FRONT VIEW)

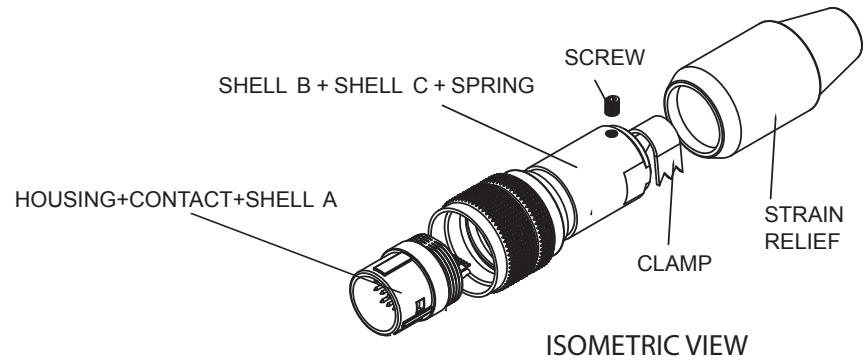

ISOMETRIC VIEW

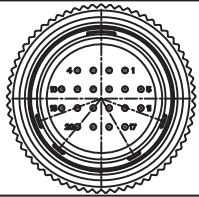
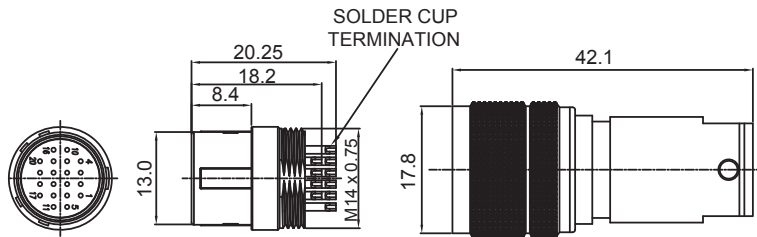

HOUSING+CONTACT+SHELL A

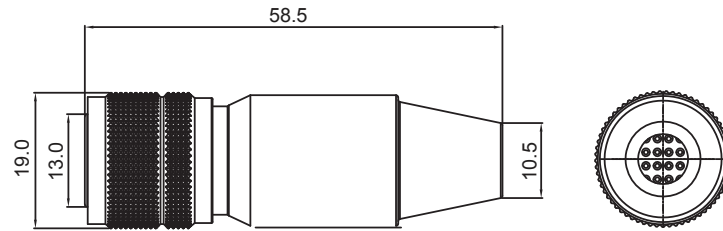

SHELL B + SHELL C + SPRING

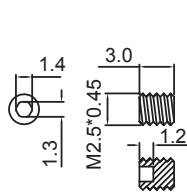

SCREW

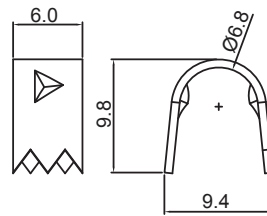

CLAMP

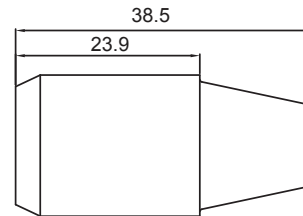
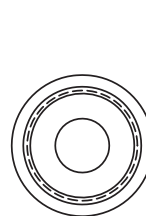

STRAIN RELIEF

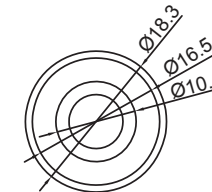

**MATERIAL:**

HOUSING: Nylon 46 (UL94V-0) Black  
 CONTACT: Copper Alloy, Au Flash Plated  
 SHELL A: Zinc Alloy  
 SHELL B & C: Copper Alloy  
 SPRING: Stainless Steel  
 SCREW: Steel Alloy, Nickel Plated

**HOW TO ORDER:**

P P 3 3 - 2 0 0 1 - 0 0 0 0 - Z

**# OF POSITIONS:**  
20 - 20 Positions

**RoHS**  
**COMPLIANT**

Rev	Drawn	Checked	Approved	Date	
0	B.S.	S.M.	S.M.	08/06/19	<b>SMP TECHNOLOGY, INC.</b>
					Circular Quick Lock Connector (Push Pull Type), Size 13, Cable Plug,
					Solder Cup Termination
TOL. DEC.	.X +/- 0.20	.XX +/- 0.10	.XXX +/- 0.05	ANGLE +/- 1°	UNIT: mm
					P/N: PP33-2001-0000-Z