

SOLDER CUP TERMINATION

HOUSING+CONTACT+SHELL A

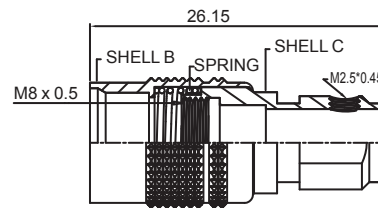

SHELL B + SHELL C + SPRING

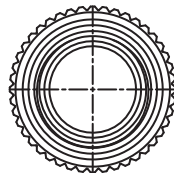
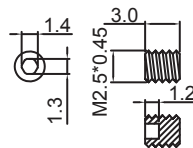
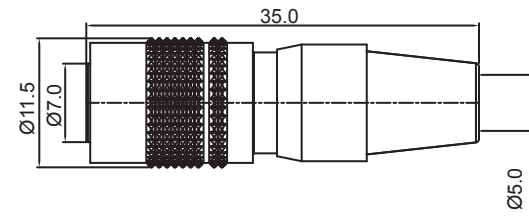

SCREW

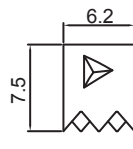

CLAMP

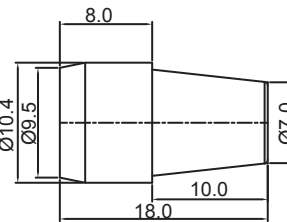
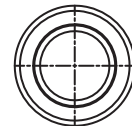

STRAIN RELIEF

MATERIAL:

HOUSING: Nylon 46 (UL94V-0) Black
 CONTACT: Copper Alloy, Au Flash Plated
 SHELL A: Zinc Alloy
 SHELL B & C: Copper Alloy
 SPRING: Stainless Steel
 SCREW: Steel Alloy, Nickel Plated

HOW TO ORDER:

P P 1 3 - X X 0 1 - 0 0 0 0 - Z

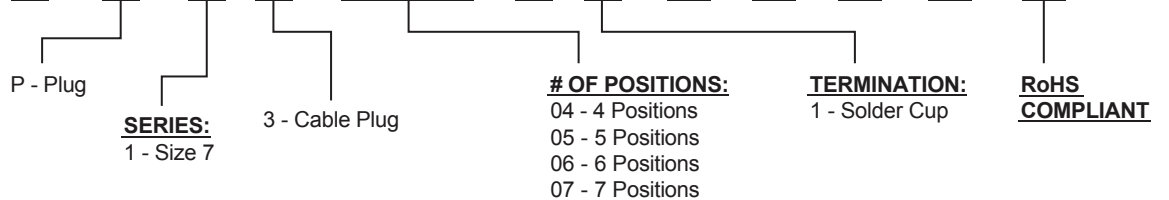

Rev	Drawn	Checked	Approved	Date
0	B.S.	S.M.	S.M.	08/06/19

SMP TECHNOLOGY, INC.

Circular Quick Lock Connector (Push Pull Type), Size 7, Cable Plug

Solder Cup Termination