

Recommended PCB Layout
Bottom View

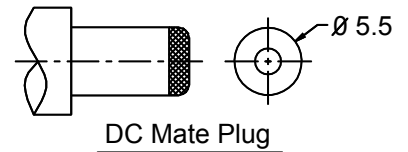

ELECTRICAL:

CONTACT RESISTANCE: < 30mΩ
 INSULATOR RESISTANCE: > 50MΩ
 DIELECTRIC WITHSTANDING VOLTAGE: 250VAC FOR 1 MIN.
 OPERATING TEMPERATURE: -40°C TO +105°C

MATERIAL:

INSULATOR: PBT (UL94V-0)
 SIGNAL CONTACT: COPPER ALLOY, TIN PLATED
 GROUND CONTACT: COPPER ALLOY, TIN PLATED
 TERMINAL: COPPER ALLOY, SILVER PLATED
 MOUNTING PIN: COPPER ALLOY, NICKEL PLATED

HOW TO ORDER:

P 0 0 2 - X 0 0 0 - 1 0 0 - Z

CENTER PIN DIAMETER:
 5 - 1.87mm
 6 - 2.0mm
 7 - 2.5mm

PCB MOUNTING OPTIONS:
 1 - TAPERED PC TAIL

RoHS COMPLIANT

Rev	Drawn	Checked	Approved	Date
0	A.M.	S.M.	S.M.	06/05/03
A	D.H.	S.M.	S.M.	06/05/04
B	B.S.	S.M.	S.M.	07/14/08
C	B.S.	S.M.	S.M.	06/30/17

SMP TECHNOLOGY, INC.

DC Power Jack, Right Angle, Thru Hole, Tapered PC TAIL Tail, 1.87mm, 2.0mm, 2.5mm Pin Diameter