

ELECTRICAL:

CURRENT RATING: 0.4A
 VOLTAGE RATING: 50 VDC
 CONTACT RESISTANCE: 20 mΩ
 INSULATOR RESISTANCE: 500 MΩ
 DIELECTRIC WITHSTANDING VOLTAGE: AC 200V / 60sec.
 OPERATING TEMPERATURE: -55°C to +85°C

MATERIAL:

TERMINAL: Phosphor Bronze, Tin-Plated
 FITTING NAIL: Brass, Tin-Plated
 HOUSING: Thermoplastic (UL94V-0)

HOW TO ORDER:

F 2 1 4 - X X 2 C - X 0 X - Z X

NUMBER OF CONTACTS:
 04 to 50 - SEE TABLE PAGE 2

CONTACT POINT:
 3 - UPPER CONTACT
 4 - LOWER CONTACT

PACKAGING:
 0 - TUBE
 1 - TRAY
 2 - TAPE & REEL

PLATING:
 Blank - Bright Tin Plate
 1 - Au Flash Plating
 2 - Matte Tin Plating

FOOTPRINT:
 0 - STANDARD

RoHS COMPLIANT

Rev	Drawn	Checked	Approved	Date
0	B.S.	S.M.	S.M.	10/01/14

SMP TECHNOLOGY, INC.
 FFC Connector, 0.5mm Pitch, Side Entry, ZIF, Surface Mount
 Standard Footprint, 1.2mm Height

TOL. DEC. .X +/- 0.25 .XX +/- 0.20 .XXX +/- 0.15 ANGLE +/- 1° UNIT: mm

P/N: F214-XX2C-X0X-ZX

# CKTS	A	B	C	D	# CKTS	A	B	C	D
4	8.00	6.80	1.50	2.60	28	20.00	18.80	13.50	14.60
5	8.50	7.30	2.00	3.10	29	20.50	19.30	14.00	15.10
6	9.00	7.80	2.50	3.60	30	21.00	19.80	14.50	15.60
7	9.50	8.30	3.00	4.10	31	21.50	20.30	15.00	16.10
8	10.00	8.80	3.50	4.60	32	22.00	20.80	15.50	16.60
9	10.50	9.30	4.00	5.10	33	22.50	21.30	16.00	17.10
10	11.00	9.80	4.50	5.60	34	23.00	21.80	16.50	17.60
11	11.50	10.30	5.00	6.10	35	23.50	22.30	17.00	18.10
12	12.00	10.80	5.50	6.60	36	24.00	22.80	17.50	18.60
13	12.50	11.30	6.00	7.10	37	24.50	23.30	18.00	19.10
14	13.00	11.80	6.50	7.60	38	25.00	23.80	18.50	19.60
15	13.50	12.30	7.00	8.10	39	25.50	24.30	19.00	20.10
16	14.00	12.80	7.50	8.60	40	26.00	24.80	19.50	20.60
17	14.50	13.30	8.00	9.10	41	26.50	25.30	20.00	21.10
18	15.00	13.80	8.50	9.60	42	27.00	25.80	20.50	21.60
19	15.50	14.30	9.00	10.10	43	27.50	26.30	21.00	22.10
20	16.00	14.80	9.50	10.60	44	28.00	26.80	21.50	22.60
21	16.50	15.30	10.00	11.10	45	28.50	27.30	22.00	23.10
22	17.00	15.80	10.50	11.60	46	29.00	27.80	22.50	23.60
23	17.50	16.30	11.00	12.10	47	29.50	28.30	23.00	24.10
24	18.00	16.80	11.50	12.60	48	30.00	28.80	23.50	24.60
25	18.50	17.30	12.00	13.10	49	30.50	29.30	24.00	25.10
26	19.00	17.80	12.50	13.60	50	31.00	29.80	24.50	25.60
27	19.50	18.30	13.00	14.10					

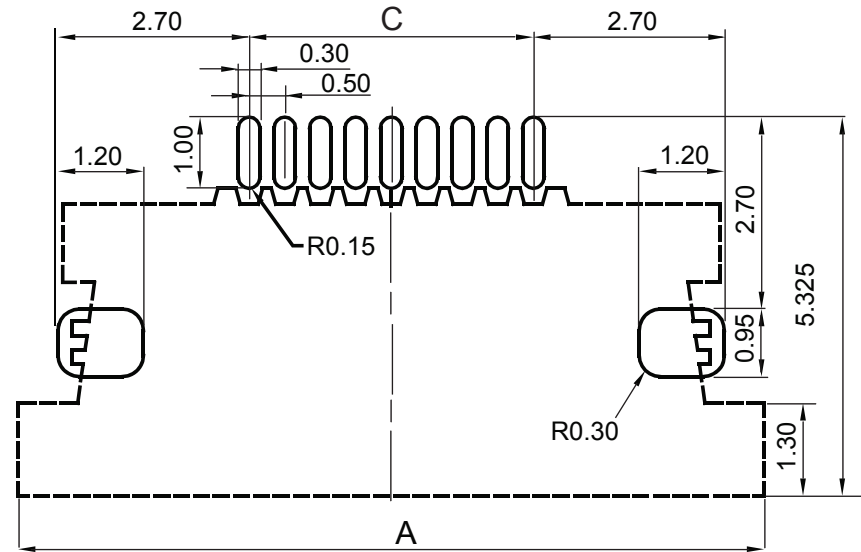

RECOMMENDED PCB LAYOUT
(COMPONENT SIDE)

SMP TECHNOLOGY, INC.

FFC Connector, 0.5mm Pitch, Side Entry, ZIF, Surface Mount

Standard Footprint, 1.2mm Height