

D045-0300-000

D045-0301-000

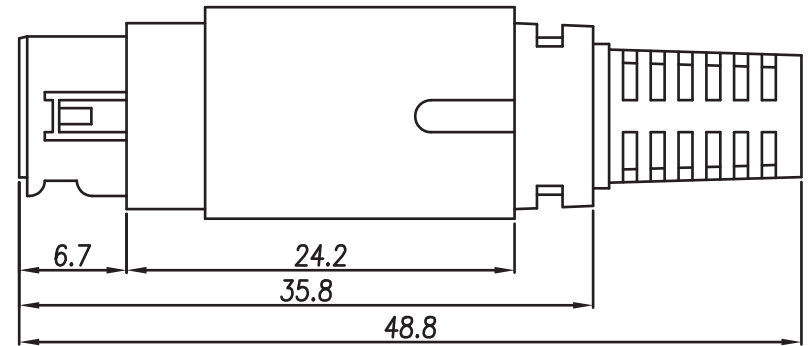
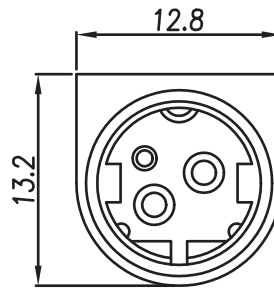
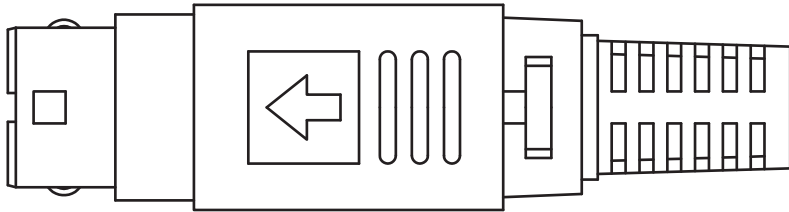

ELECTRICAL

- Current Rating : 100V AC or 12V DC 2 AMP Max
- Insulation Resistance : 50 ohm Min @ 250 V DC
- Dielectric Withstanding Voltage : 250V AC for 1 minute
- Operating Temperature : -20°C to 105°C

MATERIAL

- Insulator Contact (PBT 94 V-O Rated)
- Contact : Silver – 30u" Plated Brass
- Shell : Brass
- Spring : Steel

HOW TO ORDER:

D 0 4 5 - 0 3 0 0 - 0 0 0 - Z

**RoHS
COMPLIANT**

Rev	Drawn	Checked	Approved	Date
0 Issued	A.M.	S.M.	S.M.	10/02/03
A Revised	MDH	S.M.	S.M.	09/22/04
B Revised for RoHS Compliance	B.S.	S.M.	S.M.	12/15/06

SMP TECHNOLOGY, INC.

SCALE:n/a
 TOL. DEC. .X +/- 0.1 .XX +/- 0.05 .XXX +/- ANGLE +/- UNIT: mm

Power Mini Din, 3 Position

P/N:D045-0300-000-Z