

DISTANCES BETWEEN CONNECTORS (SEE TABLE)

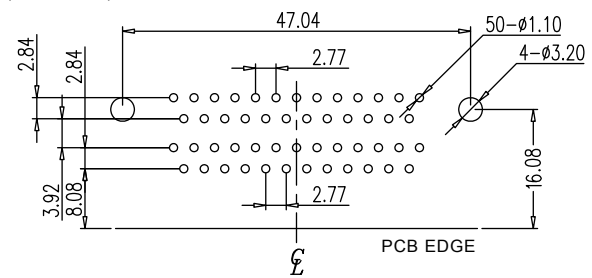
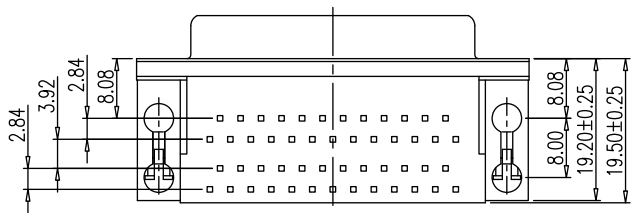

**DISTANCE BETWEEN CONNECTORS DIMENSION(mm)**

OPTION	E	F
1	15.88	28.42
2	19.05	31.60
3	22.86	35.41

RECOMMENDED PCB LAYOUT

**ELECTRICAL:**

CURRENT RATING: 3A Per Contact  
 VOLTAGE RATING: 300VDC  
 OPERATING VOLTAGE: 500V  
 CONTACT RESISTANCE: <25 Milliohm  
 INSULATION RESISTANCE: 5000 Megaohm Min. at 500VDC  
 DIELECTRIC WITHSTANDING VOLTAGE: 1000V (rms) for 1 Minute  
 OPERATING TEMPERATURE: -55°C to +105°C

**MATERIAL:**

INSULATOR: THERMOPLASTIC W/ GLASS FIBER FILLED (UL94V-0)  
 CONTACT: COPPER ALLOY  
 SHELL: STEEL, NICKEL PLATED  
 CONTACT PLATING: GOLD ON MATING SURFACE  
 Sn ON TERMINATION END  
 ALL OVER 50 μ" NICKEL

**HOW TO ORDER:**

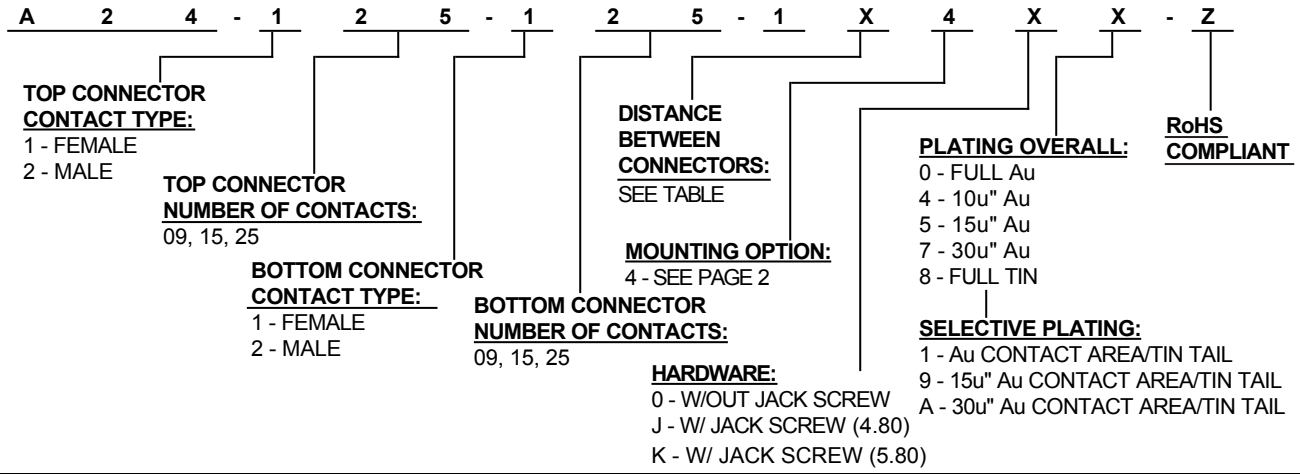

Rev	Drawn	Checked	Approved	Date
0	S.E.	S.M.	S.M.	10/01/98
A	B.S.	S.M.	S.M.	12/15/06
B	B.S.	S.M.	S.M.	07/19/18

**SMP TECHNOLOGY, INC.**  
 Dual D-SUB CONNECTOR, 25 Position Female Over 25 Position Female, 2 Boardlocks

SCALE: N/A  
 TOL. DEC. .X +/- 0.25 .XX +/- 0.20 .XXX +/- 0.15 ANGLE +/- UNIT: mm

P/N: A24-125-125-1X4XX-Z  
 Pg: 1 of 2

**OPTION 1:**  
FOUR .125 DIAMETER  
NON-THREADED  
MOUNTING HOLES

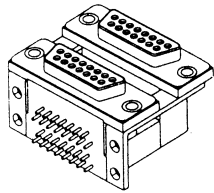

**OPTION 2:**  
FOUR THREADED 4-40  
MOUNTING HOLES

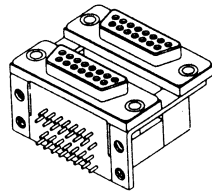

**OPTION 3:**  
FOUR GROUNDING  
BRACKETS

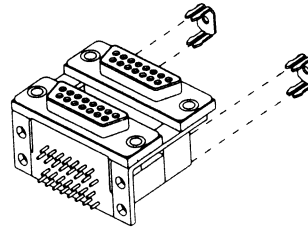

**OPTION 4:**  
TWO GROUNDING  
BRACKETS

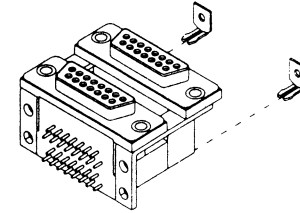

Rev		Apv.	Date	<b>SMP TECHNOLOGY, INC.</b>
SCALE	MAT'L	FINISH	MOUNTING OPTIONS	
				SERIES: A 2 5
				Pg: 2