

DISTANCE BETWEEN CONNECTORS OPTIONS:

DIMENSION(mm)

OPTION	E	F
1	15.88	28.42
2	19.05	31.60
3	22.86	35.41



LEAD FREE

ELECTRICAL:
 CURRENT RATING: 3A per Contact
 VOLTAGE RATING: 250 VAC (rms)Max.
 CONTACT RESISTANCE:
 < 25 Milliohm Max.
 INSULATION RESISTANCE:
 5000 Megaohm Min. at 500VDC
 DIELECTRIC WITHSTANDING VOLTAGE:
 1000V (rms) for 1 Minute
 OPERATING TEMPERATURE: -55°C to +105°C

MATERIAL:
 INSULATOR: TOP & BOTTOM PA9T - (UL94V-0)
 CONTACT: COPPER ALLOY
 SHELL: STEEL
 CONTACT PLATING: GOLD ON MATING SURFACE
 Sn ON TERMINATION END
 ALL OVER 50 µ" NICKEL

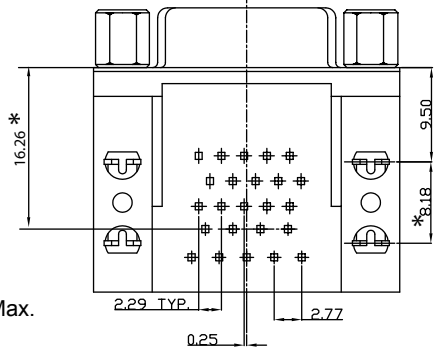
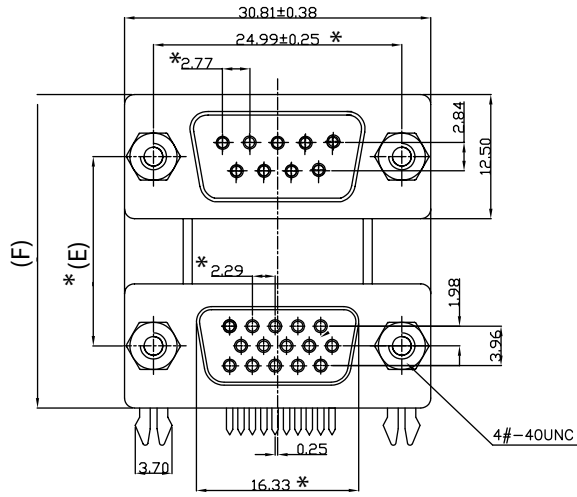

Hardware - Shown with Jackscrews Installed

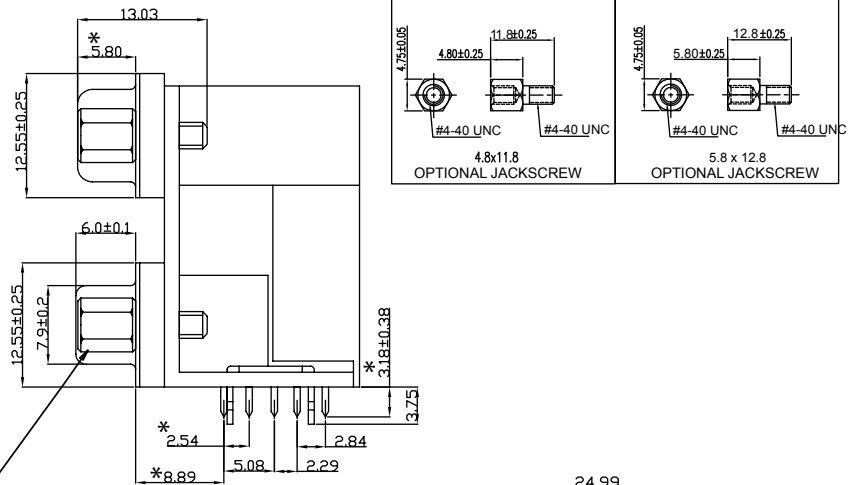

* Inspection Dimensions

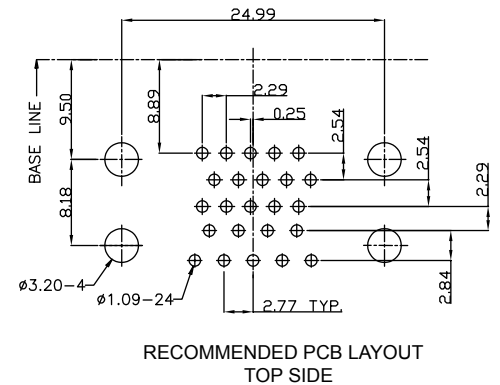

HOW TO ORDER

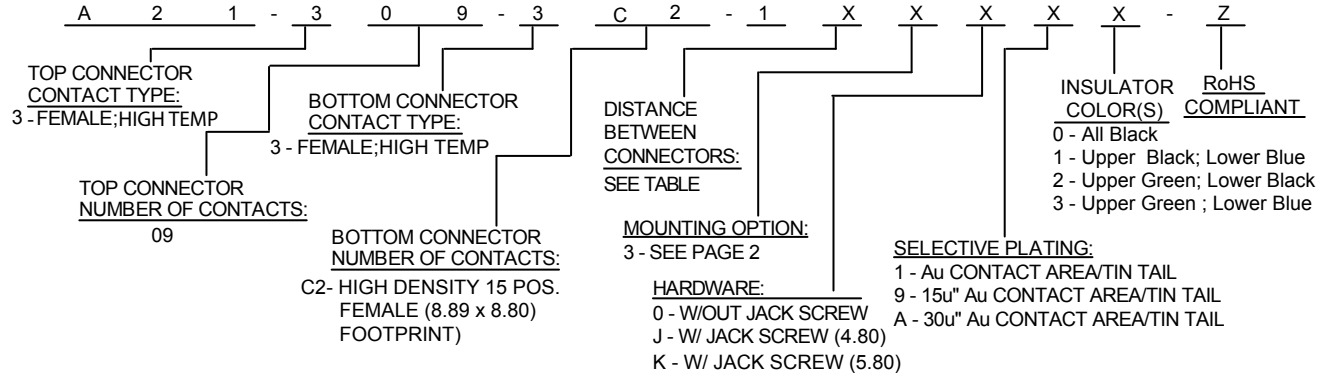

Rev	Drawn	Checked	Approved	Date
0 Issued	B.S.	S.M.	S.M.	1/05/15

SMP TECHNOLOGY, INC.

Dual D-Sub Connector, 9 Position Female Over 15 Position High Density

Female (8.89 x 8.80 mm Footprint) ; High Temp. Insulator

SCALE:n/a

TOL. DEC. .X +/-0.25 .XX +/- 0.10 .XXX +/- 0.05 ANGLE +/-2° UNIT: mm

P/N: A21-309-3C2-1XXXXX-Z

Pg: 1

PCB MOUNTING OPTIONS:

OPTION 1:
FOUR .125 DIAMETER
NON-THREADED
MOUNTING HOLES

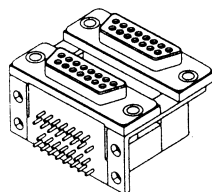

OPTION 2:
FOUR THREADED 4-40
MOUNTING HOLES

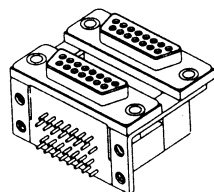

OPTION 3:
FOUR GROUNDING
BRACKETS

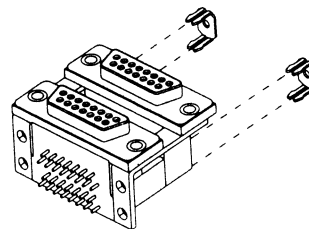

OPTION 4:
TWO GROUNDING
BRACKETS

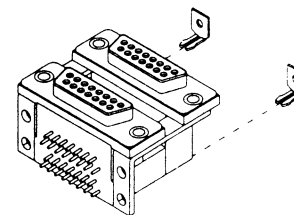

Rev		Apv.	Date	SMP TECHNOLOGY, INC.
SCALE				MOUNTING OPTIONS
				SERIES: A 2 5
				Pg: 2