

DIMENSION(mm)

CONTACTS	A	B	C	D	E	F	G
15	16.30	25.00	30.80	19.15	7.04	2.29	0.89
26	24.60	33.30	39.20	27.60	6.88	2.29	0.64
44	38.35	47.05	53.05	41.10	6.88	2.29	0.64
62	54.80	63.50	69.40	57.40	6.99	2.41	0.62

ELECTRICAL :

CURRENT RATING: 5A
 CONTACT RESISTANCE: < 30m Ω
 INSULATOR RESISTANCE: > 1000M Ω
 DIELECTRIC WITHSTANDING VOLTAGE: 1000V AC FOR 1 MIN.
 OPERATING TEMPERATURE: -55° C TO +105° C

MATERIAL :

CONTACT: COPPER ALLOY
 INSULATOR: PBT & 30% GLASS FIBER (UL94V-0); COLOR: BLACK-STANDARD
 SHELL - NICKEL PLATED STEEL

HOW TO ORDER:

A 1 6 1 - X X 0 4 - X X X - X - Z

CONTACT TYPE:
1 - FEMALE

NUMBER OF CONTACTS:

- 15
- 26
- 44
- 62

RECOMMENDED P.C.B. LAYOUT

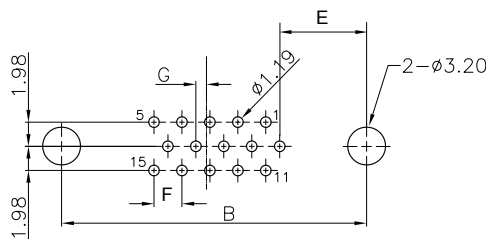

MOUNTING OPTION:
SEE PAGE 2

PLATING OVERALL:

- 0 - FULL Au
- 4 - 10u" Au
- 5 - 15u" Au
- 7 - 30u" Au
- 8 - FULL TIN

SELECTIVE PLATING:

- 1 - Au CONTACT AREA/TIN TAIL
- 9 - 15u" Au CONTACT AREA/TIN TAIL
- A - 30u" Au CONTACT AREA/TIN TAIL

INSULATOR COLOR:

- BLANK - BLACK
- 1 - WHITE
- 2 - BLUE
- 3 - GRAY

RoHS COMPLIANT

Rev	Drawn	Checked	Approved	Date
0 Issued	S.E.	S.M.	S.M.	10/1/97
A Revised for RoHS Compliance	B.S.	S.M.	S.M.	6/12/07

SMP TECHNOLOGY, INC.

SCALE: N/A D-SUB CONNECTOR, HIGH DENSITY, STRAIGHT, PCB MOUNT, FEMALE

TOL. DEC. .X +/- 0.25 .XX +/- 0.15 .XXX +/-0.05 ANGLE +/- 1° UNIT: mm

P/N: A161-XX04-XXX-X-Z

A031 & A032 MOUNTING OPTIONS

MOUNTING OPTION 10

3.05 MM DIAMETER NON-THREADED MOUNTING HOLE

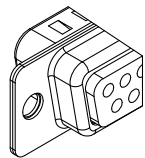

MOUNTING OPTION 11 :

RIVETED 4-40 UNC SCREW LOCK 4.0 mm ON BACK SIDE OF SHELL

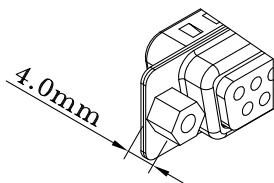

MOUNTING OPTION 12 :

RIVETED 4-40 UNC SCREW LOCK ON FRONT SIDE OF SHELL

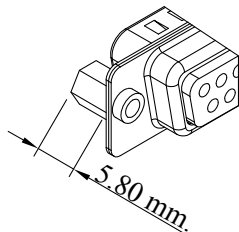

MOUNTING OPTION 14 :

4.1 mm RIVETED 4-40 SCREW LOCK ON BOTTOM SIDE OF SHELL

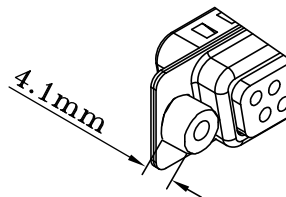

MOUNTING OPTION 16 :

3.5 mm RIVETED 4-40 SCREW LOCK ON BOTTOM SIDE OF SHELL

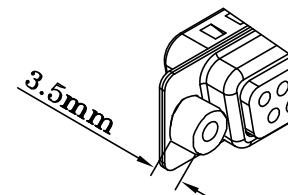

* For Mounting Options 11, 12 & with Nylok installed on inside threads - replace the "1" with the letter L. Example: Option 11 with Nylok installed - use mounting option L1.

MOUNTING OPTION 17 :

RIVETED 4-40 UNC SCREW LOCK ON FRONT SIDE OF SHELL

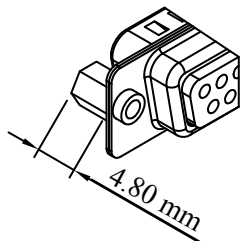

MOUNTING OPTION 19 :

RIVETED 4-40 UNC SCREW LOCK 5.8mm ON BACK SIDE OF SHELL

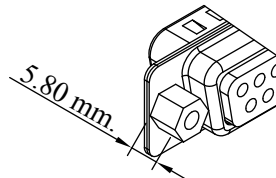

MOUNTING OPTION 20:

RIVETED 5.80 mm 4-40 UNC SCREW LOCK ON BACK SIDE OF SHELL; 5.80 mm UNC SCREWLOCK ATTACHED TO FRONT SIDE OF SHELL

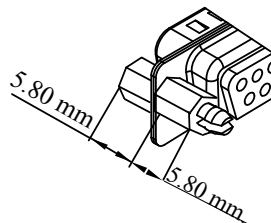

MOUNTING OPTION 21:

RIVETED 5.80 mm 4-40 UNC SCREW LOCK ON BACK SIDE OF SHELL; 4.80 mm UNC SCREWLOCK ATTACHED TO FRONT SIDE OF SHELL

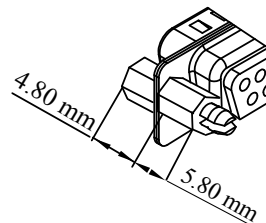

MOUNTING OPTION 22:

RIVETED 5.80 mm 4-40 UNC SCREW LOCK ON BACK SIDE OF SHELL;

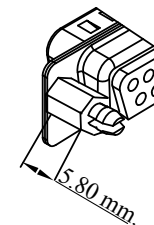

MOUNTING OPTION 23:

RIVETED 5.80 mm 4-40 UNC SCREW LOCK ON BACK SIDE OF SHELL;

