

$$A = (\text{Pitch} \times \text{No. of contact} + 0.4) \pm 0.25$$

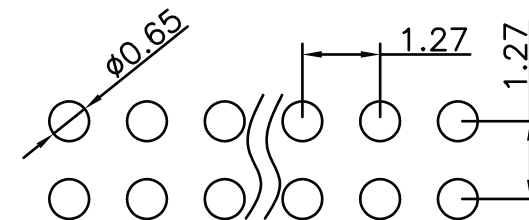
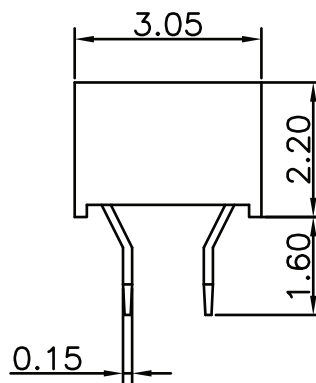
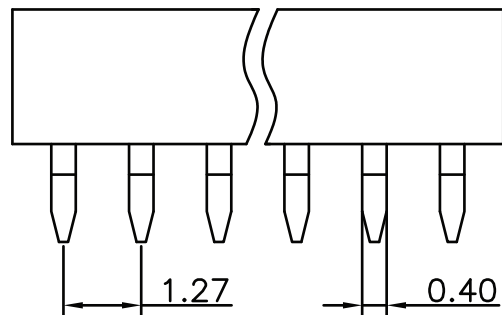
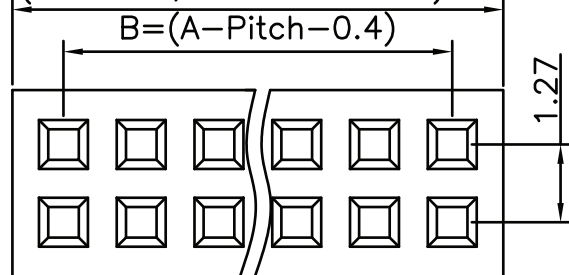

P.C.B LAYOUT

ELECTRICAL:

CURRENT RATING: 1A
 CONTACT RESISTANCE:
 <30 Milliohm Max
 INSULATION RESISTANCE:
 >5000 Megaohm Min
 DIELECTRIC WITHSTANDING VOLTAGE:
 600V (RMS) AC for 1 Minute
 OPERATING TEMPERATURE: -40°C to +105°C

MATERIAL:

INSULATOR: Nylon 6T UL94V-0
 CONTACT: Phosphor Bronze

MATERIAL:

DURABILITY: 50 Cycles
 RETENTION FORCE: 300g Min
 INSERTION FORCE: 56g
 SOLDERABILITY: Per MIL-STD-202F Method 208D
 MAX. PROCESSING TEMPERATURE: 260°C for 10 seconds

HOW TO ORDER:

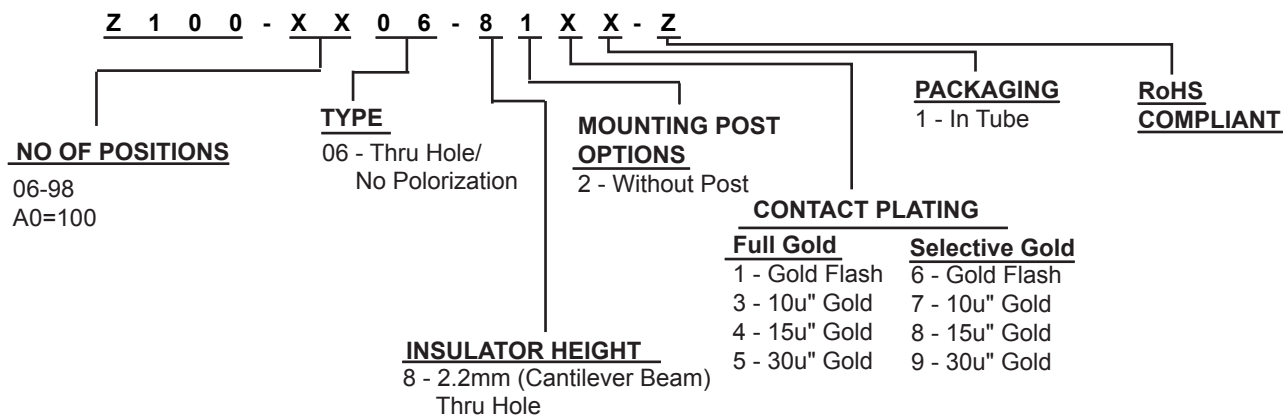

| Rev | Drawn | Checked | Approved | Date |
|-----|-------|---------|----------|---------|
| 0 | B.S. | S.M. | S.M. | 9/26/07 |

SMP TECHNOLOGY, INC.

Receptacle Assembly; 1.27mm x 1.27mm; Top Entry; Thru Hole;

SCALE 2.2mm Height

TOL. DEC. .X +/- 0.3 .XX +/- 0.2 .XXX +/- 0.1 ANGLE +/- 5° UNIT: mm

P/N: Z100-XX06-81XX-Z