

Isometric View

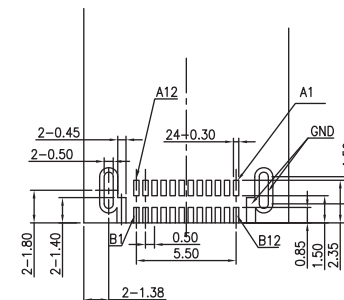
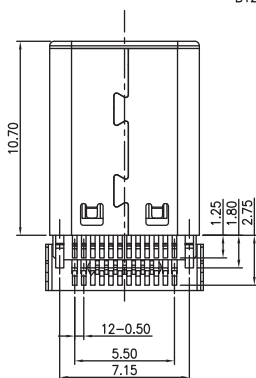
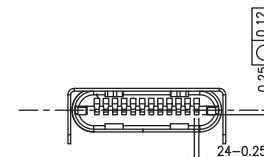
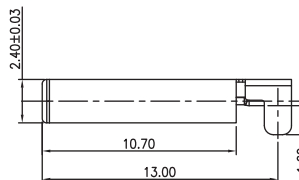
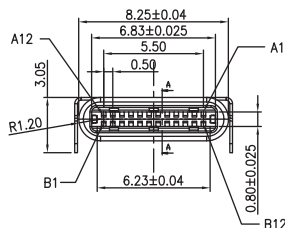
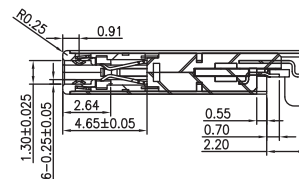
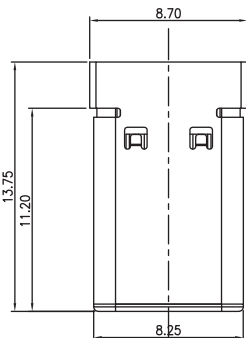

Recommended PCB Layout

ELECTRICAL:

CURRENT RATING: 5A Min. for VBUS,
1.25A Min. for Other

CONTACT RESISTANCE:
< 40 milliohm Max.

INSULATION RESISTANCE:
> 100 Mgeaohm Min.

DIELECTRIC WITHSTANDING VOLTAGE:
100 VAC for 1 Minute

OPERATING TEMPERATURE: - 40° C ~ 85° C

MATERIAL:

INSULATOR: LCP, UL94V-0

CONTACTS: Copper Alloy

CONTACT PLATING:

Gold Plating over 50u" Nickel on Contact Area,
80u" Tin/ Plating over 50u" Nickel on Solder Area

SHELL: Stainless Steel with 50u" Nickel Plating

Mechanical:

INSERTION FORCE: 5 ~ 20N Max.

WITHDRAWAL FORCE: 8 ~ 20N Kg

DURABILITY: 10,000 Cycles

HOW TO ORDER:

U X 1 5 - 0 2 0 4 - 3 0 X X - Z

BODY STYLE

0 - Male Right Angle

OF POSITIONS

02 - 24 Position SMT

MOUNTING STYLE

04 - Surface Mount Male
7.15mm Between Legs

CONTACT AREA PLATING

0 - 4u" Au
1 - 7u" Au
2 - 10u" Au
3 - 15u" Au
4 - 30u" Au

PACKAGING

0 - Tray
2 - Tape & Reel

ROHS COMPLIANT

Insulator Color

0 - Black
1 - Blue

Rev	Drawn	Checked	Approved	Date
0	B.S.	S.M.	S.M.	12/10/15

SMP TECHNOLOGY, INC.

USB 3.1 Male Connector, Surface Mount with DIP Shell Legs, 1.45mm Offset

SCALE :N/A
TOL. DEC. .X +/- 0.30 .XX +/- 0.20 ANGLE +/- 5° UNIT: mm

SERIES: UX15-0204-30XX-Z