

ISOMETRIC VIEW

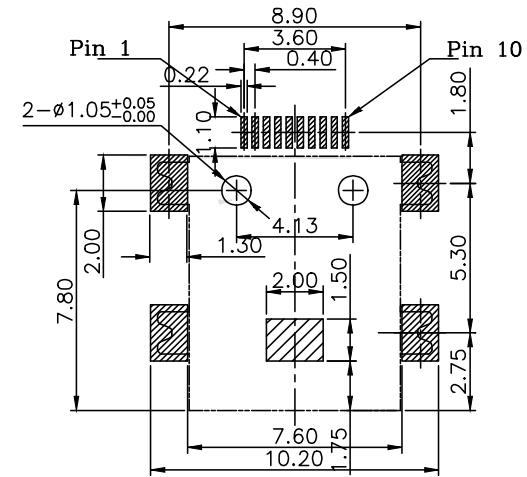
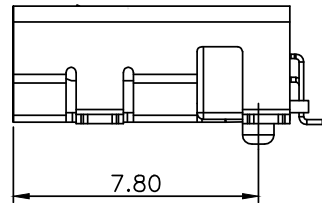
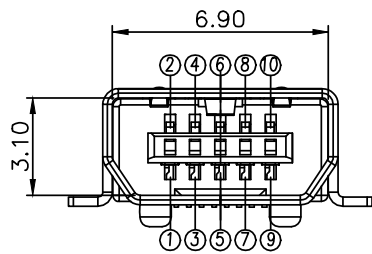

RECOMMENDED PCB LAYOUT

MATERIAL:

Housing: LCP
 Shell: Copper Alloy; Nickel Plated
 Terminal: Copper Alloy w. Selective Au plating over Nickel;
 Tin Plated over Nickel in Solder Tail area

ELECTRICAL:

Signal Contact Current Rating: 1.0 AMP Max.
 Signal Contact Resistance: 40.0 milliohms MAX.
 Dielectric Withstanding Voltage: 100 VAC For 1 Minute
 Insulation Resistance: 500 Megaohms
 Operating Temperature Range : -55°C ~ 85°C

HOW TO ORDER:

U 0 0 3 - T 0 J 0 - 1 7 X - Z X

INSULATOR COLOR:
 0 - Black

SELECTIVE CONTACT PLATING

- 2 - Au Flash
- 3 - 15 u" Au
- 4 - 30 u" Au

RoHS COMPLIANT

PACKAGING

- 1- Tray
- 2- Tube
- 4 - Tape & Reel

Rev	Drawn	Checked	Approved	Date
0 Issued	B.S.	S.M.	S.M.	02/27/13

SMP TECHNOLOGY, INC.

Mini USB Receptacle; Right Angle; 10 Position; Surface Mount

Phillips Style

TOL. DEC. .X +/- 0.3 .XX +/- 0.25 .XXX +/- 0.15 ANGLE +/- 2° UNIT: mm

U003-T0J0-17X-ZX