

Isometric View

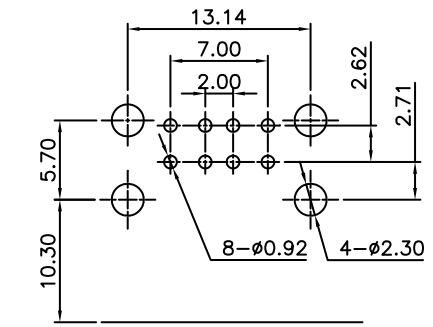

Recommended P.C. Board Layout

ELECTRICAL:

CURRENT RATING: 1A
 CONTACT RESISTANCE:
 < 30 Milliohm Max.
 INSULATION RESISTANCE:
 > 1000 Mgeaohm Min.
 DIELECTRIC WITHSTANDING VOLTAGE:
 500 VAC for 1 Minute
 OPERATING TEMPERATURE: -55° C to +125° C

MATERIAL:

INSULATOR: Thermoplastic UL94V-0
 CONTACTS: Phosphor Bronze
 CONTACT PLATING:
 Gold Plating over Nickel on Contact Area,
 100u" Tin on PC Tail
 SHELL: Brass
 SHELL PLATING: Nickel

MECHANICAL:

MATING FORCE: 3.57 Kgf Max.
 UNMATING FORCE: 1.02 Kgf Min.

RECOMMENDED PC BOARD THICKNESS OF 1.57mm

HOW TO ORDER:

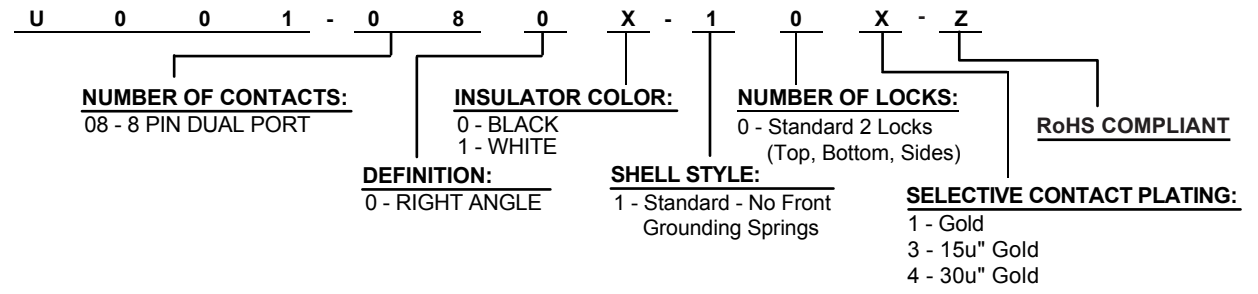

Rev	Drawn	Checked	Approved	Date
0	S.E.	B.S.	B.S.	10/1/97
A	D.H.	B.S.	B.S.	7/13/04
B	G.T.	B.S.	B.S.	10/27/05
C	G.T.	B.S.	B.S.	10/23/14

SMP TECHNOLOGY, INC.

USB Connector, A Type, 8 Position, Dual Stacked
 No Front Ground Springs

SCALE: N/A

TOL. DEC. .X +/- 0.35 .XX +/- 0.25 .XXX +/- ANGLE +/- UNIT: mm

SERIES: U001-080X-10X-Z Pg: 1