

SEC:A-A

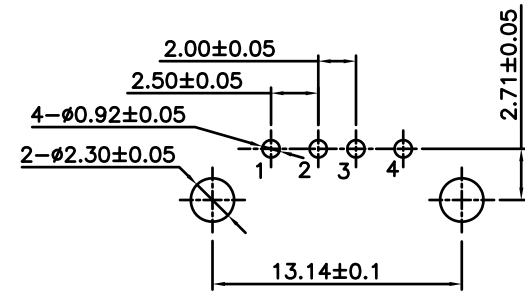

Recommended PCB Layout

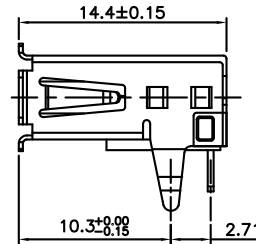
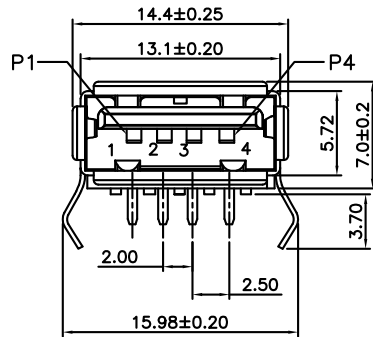
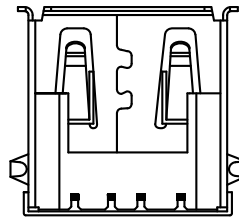

**ELECTRICAL:**

CURRENT RATING: 1.5 AMP  
 CONTACT RESISTANCE:  
 30 Milliohm Max.  
 INSULATOR RESISTANCE:  
 > 1000M Ω Min.  
 DIELECTRIC WITHSTANDING VOLTAGE:  
 500 VAC / Minute  
 OPERATING TEMPERATURE: -55° C to +85° C  
 VOLTAGE: 30V AC/DC

**MATERIAL:**

INSULATOR: Thermoplastic UL94V-0 (PBT)  
 CONTACTS: Copper Alloy  
 SHELL: Nickel Plated Brass

**HOW TO ORDER:**

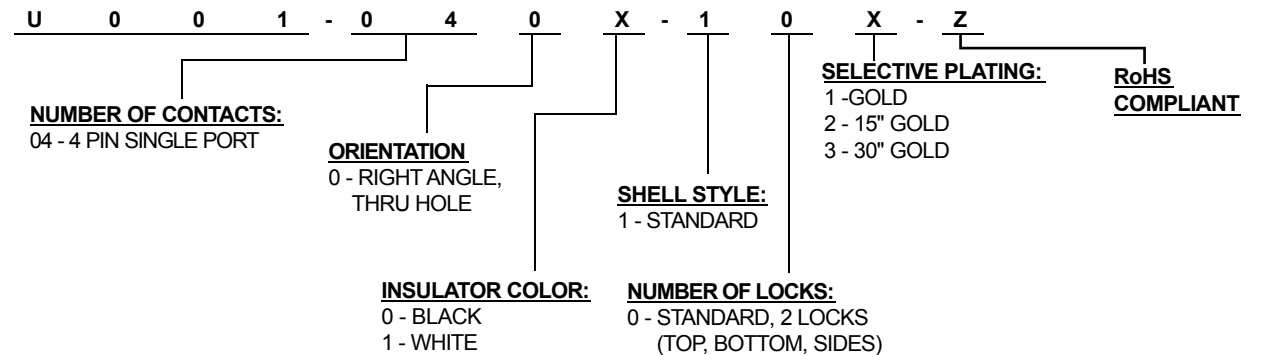

Rev	Drawn	Checked	Approved	Date
0	S.E.	S.M.	S.M.	10/1/97
A	D.H.	S.M.	S.M.	6/21/04
B	B.S.	S.M.	S.M.	12/15/06
C	B.S.	S.M.	S.M.	12/05/07
D	B.S.	S.M.	S.M.	12/05/08

<b>SMP TECHNOLOGY, INC.</b>	
USB CONNECTOR, SINGLE PORT, RIGHT ANGLE, A TYPE, THRU HOLE	