

CARD DETECTION SWITCH STATUS

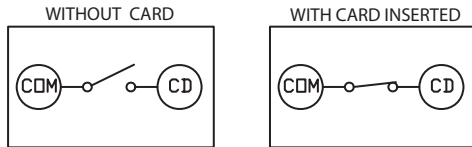

HOW TO ORDER:

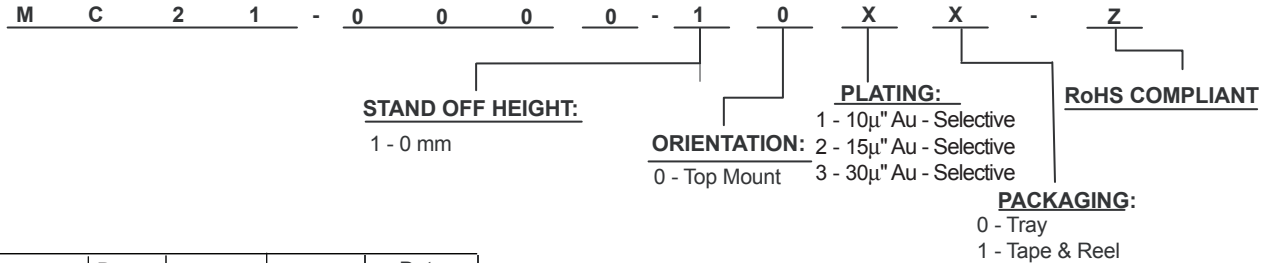

MATERIAL:

HOUSING: LCP + 30% Glass Fill , UL94V-0
 COLOR: Black
 CONTACT: Phosphor Bronze
 PLATING CONTACT AREA:
 Selective Hard Gold over 50 microinches Nickel Underplate
 PLATING SOLDERING ZONE:
 100 Microinches min. Matte Tin over 50
 Microinches Nickel Underplate

Rev	Drawn	Checked	Approved	Date
0	B.S.	S.M.	S.M.	09/20/08

SMP TECHNOLOGY, INC.

SIM Card Connector; Top Mount ; 0 mm Stand-Off; With Card Detect Switch

SCALE:n/a

TOL. DEC. .X +/- 0.20 .XX +/- 0.15 .XXX +/- 0.10 ANGLE +/- UNIT: mm

P/N: MC21-0000-10XX-Z

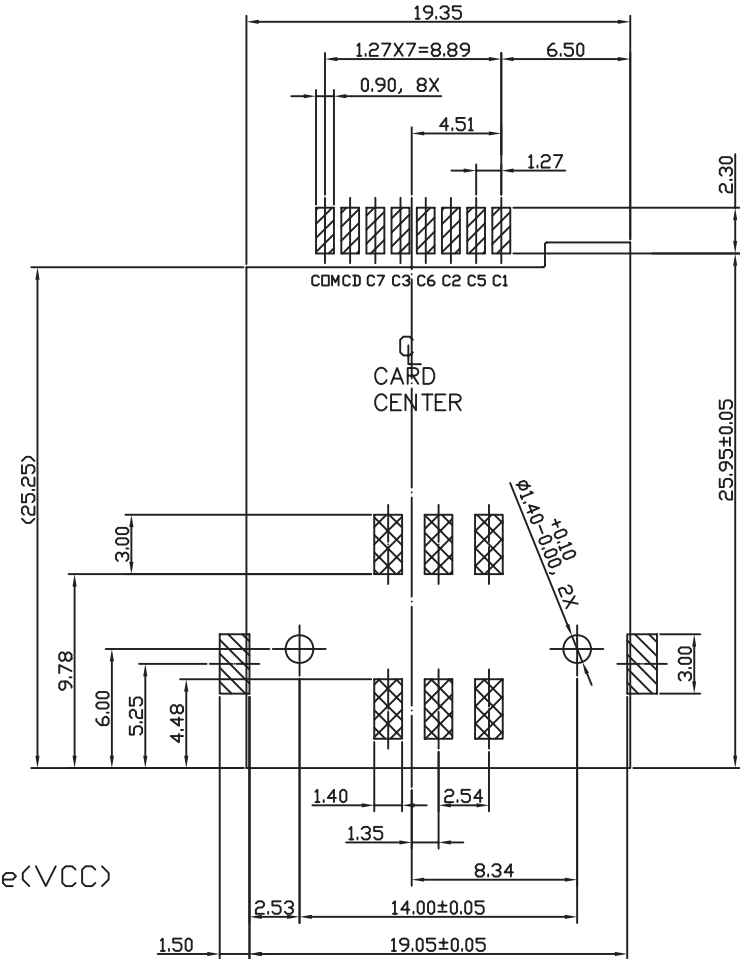
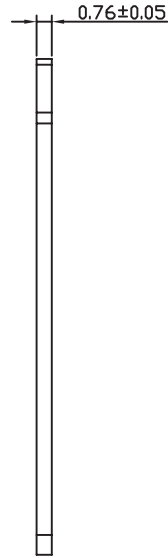
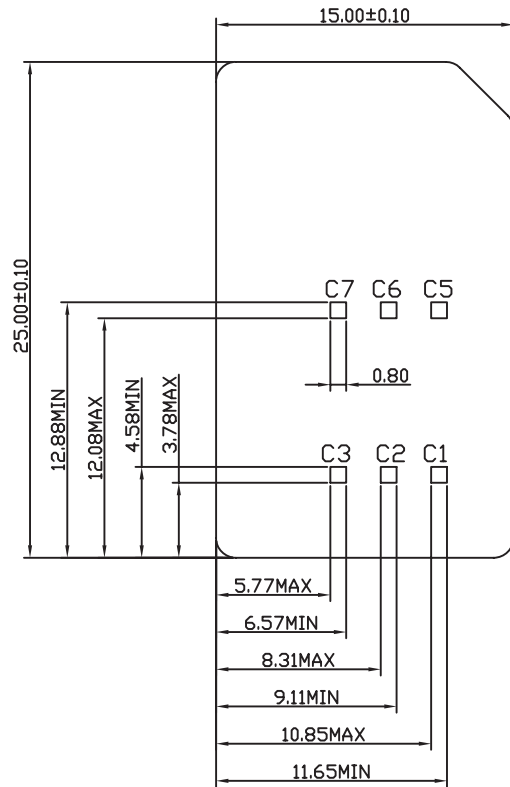

- C1 Supply voltage(VCC)
- C2 Reset(RST)
- C3 Clock(CLK)
- C4 Not used
- C5 Ground(GND)
- C6 RFU
- C7 Input/output(I/O)
- C8 Not used

APPLICABLE CARD SIZE

RECOMMENDED PCB LAYOUT

— TRACR PROHIBITION AREA

Rev	Drawn	Checked	Approved	Date
0	B.S.	S.M.	S.M.	

SMP TECHNOLOGY, INC.	
Title	