

P.C.B. LAYOUT  
TOP VIEW

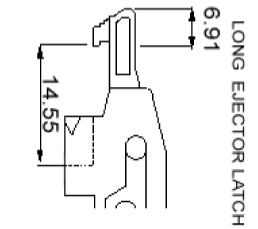
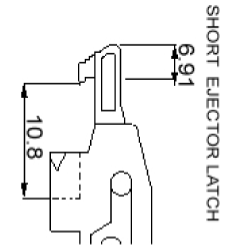
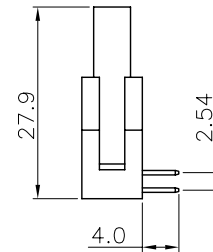
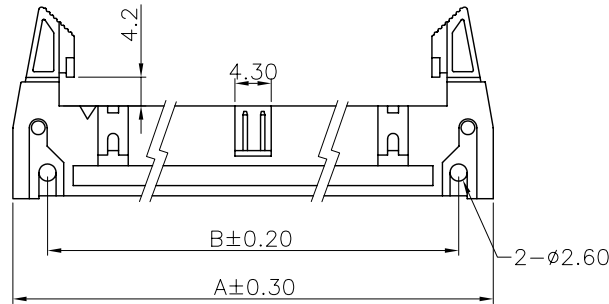
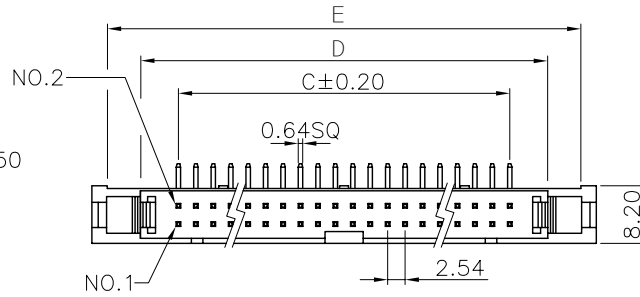

**DIMENSION(mm)**

CONTACTS	A	B	C	D	E
10	32.00	21.84	10.16	17.90	27.94
14	37.08	26.92	15.24	22.98	33.02
16	39.62	29.46	17.78	25.52	35.56
20	44.70	34.54	22.86	30.60	40.64
24	49.80	39.62	27.94	35.68	45.72
26	52.30	42.16	30.48	38.22	48.26
30	57.40	47.24	35.56	43.30	53.34
34	62.50	52.32	40.64	48.38	58.42
40	70.10	59.94	48.26	56.00	66.04
50	82.80	72.64	60.96	68.70	78.74
60	95.50	85.34	73.66	81.40	91.44
64	100.60	90.42	78.74	86.48	96.52

**ELECTRICAL:**

CURRENT: 3A  
 CONTACT RESISTANCE: < 20mΩ max.  
 INSULATOR RESISTANCE: > 1000MΩ  
 DIELECTRIC WITHSTANDING VOLTAGE: 1000VAC FOR 1 MIN.  
 OPERATING TEMPERATURE: -55° C TO +105° C

**MATERIAL:**

INSULATOR: THERMOPLASTIC, UL94V-0  
 CONTACT: COPPER ALLOY  
 CONTACT FINISH: GOLD OVER NICKEL

**HOW TO ORDER:**

**B** 1 1 1 - X X 2 X - 1 1 X - Z

**NUMBER OF CONTACTS:**

10 thru 64

**EJECTOR LATCH HEIGHT:**

0 - LONG EJECTOR LATCH FOR IDC W/ STRAIN RELIEF  
 1 - SHORT EJECTOR LATCH FOR IDC W/OUT STRAIN RELIEF  
 2 - NO EJECTOR LATCH

**COLOR:**

1 - BLACK

**PLATING OVERALL:**

0 - FULL TIN  
 1 - FULL Au  
 3 - 10u" Au  
 4 - 15u" Au  
 5 - 30u" Au

**SELECTIVE PLATING:**

6 - Au CONTACT AREA/TIN TAIL  
 7 - 10u" Au CONTACT AREA/TIN TAIL  
 8 - 15u" Au CONTACT AREA/TIN TAIL  
 9 - 30u" Au CONTACT AREA/TIN TAIL

**RoHS COMPLIANT**

**DEFINITION:**

2 - RIGHT ANGLE

Rev	Drawn	Checked	Approved	Date
0	S.E.	S.M.	S.M.	2/1/96
A	WHS	S.M.	S.M.	10/16/06

**SMP TECHNOLOGY, INC.**

BOX HEADER w/ EJECTOR, 2.54mm PITCH, RIGHT ANGLE

SCALE: N/A

TOL. DEC. .X +/- 0.30 .XX +/- 0.20 .XXX +/- 0.10 ANGLE +/- 1° UNIT: mm

SERIES: B 111 - XX2X - 11X - Z